



**MASTER SIGN PLAN
REVIEW COMMITTEE**

ADMINISTRATIVE HEARING NOTICE

The **MASTER SIGN PLAN** process has been created to afford property owners flexibility in designing site and building signage, and to allow adjacent property owners the opportunity to review/comment on signage proposals prior to their approval.

TIME & PLACE OF HEARING: The Master Sign Plan Review Committee will meet at 3:30 p.m. on Thursday, May 28, 2009 in the **Willow Room at City Hall**, 2660 Civic Center Drive.

PURPOSE: Review a request for a **MASTER SIGN PLAN** for the Har Mar Mall

SITE: 2100 Snelling Avenue

APPLICANT: Gateway Washington, Inc. (MSP09-04)

How to Participate:

1. Call or email Thomas Paschke, City Planner, at 651-792-7074 or thomas.paschke@ci.roseville.mn.us prior to the hearing. Mail a letter or fax it to 651-792-7070.
2. Attend the hearing and address the Committee.

Please see map on reverse side for property location.



**MASTER SIGN PLAN
REVIEW COMMITTEE**

ADMINISTRATIVE HEARING NOTICE

The **MASTER SIGN PLAN** process has been created to afford property owners flexibility in designing site and building signage, and to allow adjacent property owners the opportunity to review/comment on signage proposals prior to their approval.

TIME & PLACE OF HEARING: The Master Sign Plan Review Committee will meet at 3:30 p.m. on Thursday, May 28, 2009 in the **Willow Room at City Hall**, 2660 Civic Center Drive.

PURPOSE: Review a request for a **MASTER SIGN PLAN** for the Har Mar Mall

SITE: 2100 Snelling Avenue

APPLICANT: Gateway Washington, Inc. (MSP09-04)

How to Participate:

1. Call or email Thomas Paschke, City Planner, at 651-792-7074 or thomas.paschke@ci.roseville.mn.us prior to the hearing. Mail a letter or fax it to 651-792-7070.
2. Attend the hearing and address the Committee.

Please see map on reverse side for property location.

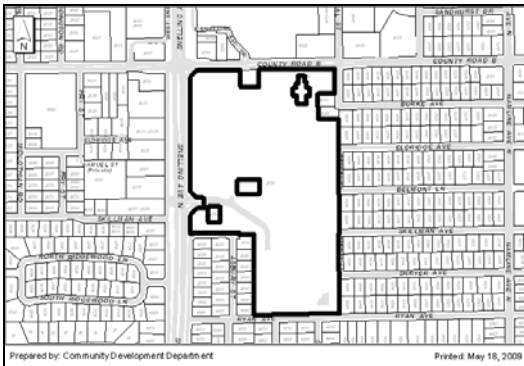

«ENPN1»
«ENPN2»
«ENPADD1»
«ENPADD2»

City of Roseville
Community Development
2660 Civic Center Drive
Roseville, MN 55113

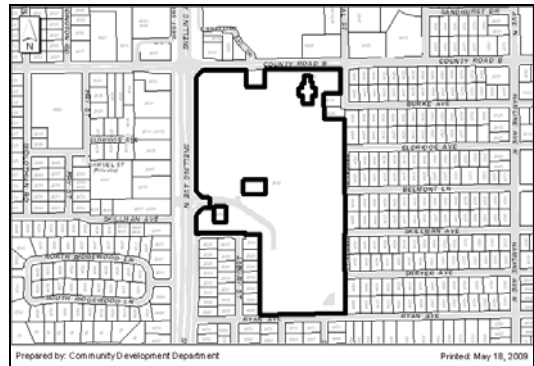

«Next Records»ENPN1»
«ENPN2»
«ENPADD1»
«ENPADD2»

City of Roseville
Community Development
2660 Civic Center Drive
Roseville, MN 55113

ENPN1	ENPN2	ENPADD1	ENPADD2
1 2125 PASCAL STREET LLC	C/O FEDDERSEN PROPERTIES	45 LEXINGTON PKWY N	ST PAUL MN 55104-6931
2 BALDEMAR BALDERRAMA		2037 SNELLING AVE N	ROSEVILLE MN 55113-5837
3 BARBARA R DANIELS	TERRY L DANIELS	1971 SIMPSON ST	ROSEVILLE MN 55113-5832
4 BETTY M CHARBONNEAU	HARVEY E CHARBONNEAU	13005 MENTZER TRL	LINDSTROM MN 55045-9420
5 CAPP INDUSTRIES INC		7951 12TH AVE S	BLOOMINGTON MN 55425-1017
6 CORRINE L GALLIMORE		1455 ELDRIDGE AVE W	ROSEVILLE MN 55113-5805
7 CRESCENSE M THOMPSON		2008 ASBURY ST	ROSEVILLE MN 55113-5821
8 DI JO MI FAMILY LTD PARTNERSHI		520 UNIVERSITY AVE	ST PAUL MN 55103-1937
9 DONNA M HOFMEISTER		1455 BELMONT LN W	ROSEVILLE MN 55113-5801
10 DOROTHY A PETERSON		1455 BURKE AVE W	ROSEVILLE MN 55113-5803
11 EUGENE C OLSEN	MARY ANN OLSEN	2000 ASBURY ST	ROSEVILLE MN 55113-5821
12 GATEWAY WASHINGTON INC	CO EMMES ASSET MGMT CO LLC	420 LEXINGTON AVE #900	NEW YORK NY 10170-0999
13 GRACE M MWASSA		2026 ASBURY ST	ROSEVILLE MN 55113-5821
14 H RICHARD KNUTSON TRUSTEE	JANE E KNUTSON	8505 FLYING CLOUD DR UNIT I329	EDEN PRAIRIE MN 55344-3946
15 HUE V HUYNH	LISA C NGUYEN	1454 COUNTY RD B W	ROSEVILLE MN 55113-4213
16 IOAN SILVAN ITTU		1970 ARONA ST	ROSEVILLE MN 55113-5857
17 JANE E KNUTSON TRUSTEE	H RICHARD KNUTSON TRUSTEE	13237 KERRY LANE	EDEN PRAIRIE MN 55346-3141
18 JANICE M DUNLAP	RODNEY J DUNLAP	1994 ASBURY ST	ROSEVILLE MN 55113-5821
19 JANIS R PYLE		1986 ASBURY ST	ROSEVILLE MN 55113-5821
20 JOHN J RIDGE	CYNTHIA L RIDGE	1454 ELDRIDGE AVE W	ROSEVILLE MN 55113-5806
21 JUDY K EDLUND		1940 FULHAM ST APT 105	ROSEVILLE MN 55113-5120
22 KATHRYN R MOORE		1454 BELMONT LN W	ROSEVILLE MN 55113-5844
23 LAURENCE D RHODES JR	SUZANNE R RHODES	2020 ASBURY ST	ROSEVILLE MN 55113-5821
24 LAVERN R MILLER	MARY L MILLER	1456 BURKE AVE W	ROSEVILLE MN 55113-5804
25 LEBEDOFF FAMILY LLLP	CO THE HONORABLE J LEBEDOFF	US COURTHOUSE SUITE 300 S FOURTH ST	MINNEAPOLIS MN 55415-2201
26 LINDA MALARK	ELIZABETH J MALARK	1455 SKILLMAN AVE W	ROSEVILLE MN 55113-5813
27 MAIN STREET PROPERTY MGMT LLC		763 KASOTA AVE SE	MINNEAPOLIS MN 55414-2842
28 MARY J WARNER		1455 RYAN AV W	ROSEVILLE MN 55113-5829
29 NATIONAL RETAIL PROPERTIES LP	ATTN PROPERTY MANAGEMENT	450 S ORANGE AVE STE 900	ORLANDO FL 32801-3339
30 NIPS INC	CO PATRICIA HALVERSON	1313 COUNTY ROAD E W	ARDEN HILLS MN 55112-3708
31 NORBERT L GRAHAM	MARY P GRAHAM	2033 ASBURY ST	ROSEVILLE MN 55113-5820
32 PATRICIA L HALVERSON	CLARENCE W HALVERSON	PO BOX 3074	BURNSVILLE MN 55337-8074
33 PATRICK K ODEN		1971 ARONA ST	ROSEVILLE MN 55113-5843
34 PHILLIP J CRUMP		2034 ASBURY ST	ROSEVILLE MN 55113-5821
35 RICHARD K BROWNLIE	JANICE M BROWNLIE	1454 SKILLMAN AVE W	ROSEVILLE MN 55113-5814
36 ROBERT B EDQUIST	LECIA J EDQUIST	1970 SIMPSON ST	ROSEVILLE MN 55113-5833
37 ROBERT BARONA	MARILYN BARONA	1455 SHRYER AVE W	ST PAUL MN 55113-5831
38 ROSEMARY J QUAYLE		1454 SHRYER AVE W	ROSEVILLE MN 55113-5830
39 TARGET CORPORATION	C/O PROPERTY TAX DEPT	PO BOX 9456	MINNEAPOLIS MN 55440-9456
40 TCF NATIONAL BANK	ATTN FACILITIES MGMT	801 MARQUETTE AVE	MINNEAPOLIS MN 55402-2807
41 THOMAS HUELSTER	JIEVY HUELSTER	1260 ROSE VISTA CT	ROSEVILLE MN 55113-6228