

ROSEVILLE

COMMUNITY DEVELOPMENT
2660 Civic Center Drive ♦ Roseville, MN 55113
Phone: (651) 792-7005 ♦ Fax: (651) 792-7070

MASTER SIGN PLAN APPLICATION

CITY CODE SECTION 1010.03
www.ci.roseville.mn.us

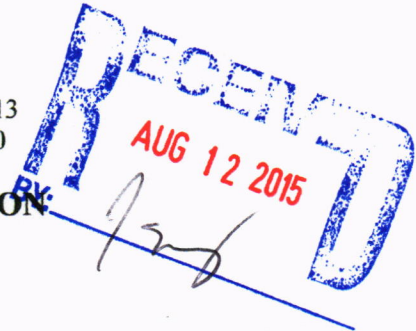

RESIDENTIAL APPLICATION FEE: \$250

COMMERCIAL APPLICATION FEE: \$350

Fee should be made payable to City of Roseville upon submittal of application.

Please complete the application by typing or printing in ink. Use additional paper if necessary.

1. Property Owner Information:

Last name: CORNER KICK LLC First name: _____
Address: 90 ST CROIX REAL ESTATE INC City/State/Zip: 101 MAIN ST NE SUITE 2 MPLS, MN 55413
Phone number: 651-426-5560 Email address: mmenellis@stcroix.com

2. Applicant Information: (if different from above)

Company name: SIGNS UNLIMITED OF PLYMOUTH
Last name: DVORACEK First name: MICHAEL
Address: 22400 HWY 55 City/State/Zip: HAWEL, MN 55340
Phone number: Cell 612-396-7636 Email address: Michael.Sigunlimited@gmail.com

3. Address of Property Involved: (if different from above)

2027-2085 RICE ST, ROSEVILLE, MN 55113

4. Additional Required Information:

- Site plan** illustrating on-site improvements and location of proposed signage
- Sign details** including sign dimensions, area calculations, and construction specifications for each sign being contemplated, as well as elevations showing wall signs and/or freestanding signs as appropriate

5. Signature(s):

By signing below, you attest that the information above and attached is true and correct to the best of your knowledge.

Property Owner: My S. McNeillis

Date: 7/23/2015

Applicant: Michael Dvoracek

Date: 6/10/15

City of Roseville
651-792-7000

08/13/2015 11:46
Receipt No. 00424304

signplan
Master Sign Pl
an 350.00

Receipt Total 350.00

Cash 0.00
Check 350.00 Check #1373
Charge 0.00

CORNER KICK

Cashier: jill.hughes
Station: RVFIN301

Thomas Paschke

From: Michael Dvoracek <michael.signsunlimited@gmail.com>
Sent: Thursday, August 06, 2015 1:46 PM
To: Thomas Paschke
Subject: RICE ST. BUSINESS CENTER SIGNAGE INFO FOR YOU

GOOD DAY THOMAS--
HERE IS SOME INFO FOR YOU--
GOING FROM SOUTH TO NORTH--
THE TSE BLDG. HAS 135' OF FRONTAGE & NO WALL SIGNS, THE DIALYSIS BLDG. HAS 120' OF
FRONTAGE AND 1 - 2' X 12' WALL SIGN, THE VACANT BUILDING HAS 135' OF FRONTAGE AND 3
- 2' X 12' WALL SIGNS AND THE KIDNEY DOCTORS/SAFEWAY BUILDING HAS 135' OF
FRONTAGE AND 2 - 2' X 12' WALL SIGNS--THAT IS 144 SQ. FT. TOTAL OF WALL SIGNS--
I THINK THAT COVERS IT--
LET ME KNOW WHAT TO DO NEXT--
THANKS FOR ALL YOUR HELP ON THIS THOMAS--
MICHAEL
MY CELL = 612-396-7636

--
Signs Unlimited Of Plymouth
Michael Dvoracek - Owner
Office 763-478-9460
Fax 763-478-2034

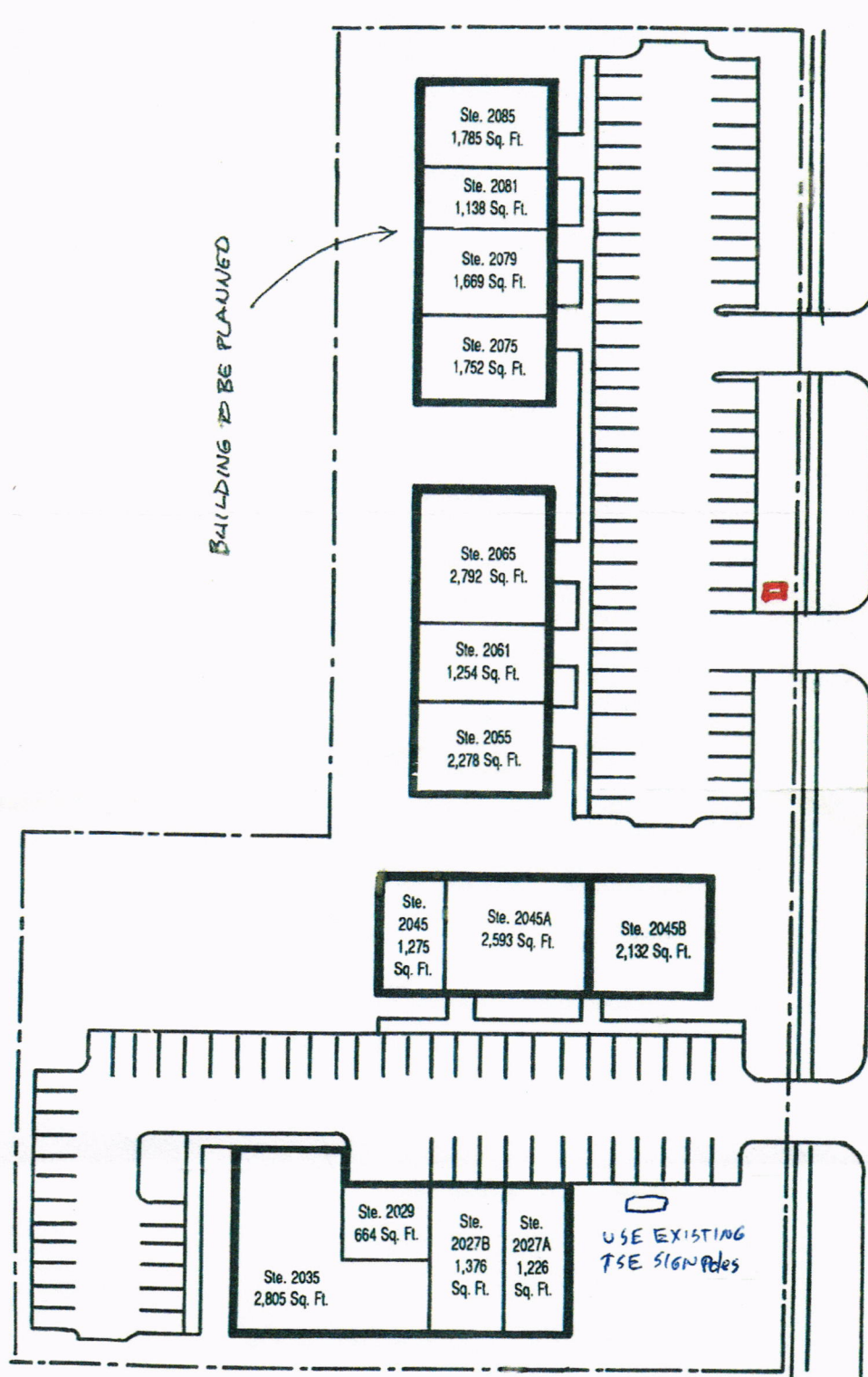

RICE STREET BUSINESS CENTER
2027 - 2085 Rice Street • Roseville, MN

DOUBLE SIDED, INTERNALLY ILLUMINATED, U.L. FABRICATED & LABELED SIGN, APPROX. 5'6" HIGH X 5' WIDE, 27.08 SQ. FT., WITH 3' HIGH ALUMINUM BASE POLE COVER



LANDLORD APPROVAL: _____ DATE: _____

CLIENT APPROVAL: _____ DATE: _____

SIGNS UNLIMITED 22400 HWY 55 HAMEL, MN 55340 OFFICE-763/478-9460 FAX-763/478-2034	RICE STREET BUSINESS CENTER 2027 - 2085 RICE ST. ROSEVILLE, MN	SCALE:	DATE: 6-10-15
	CONTENT IS PROPERTY OF SIGNS UNLIMITED, NO USE IS PERMITTED WITHOUT APPROVAL	DRAWN BY MICHAEL	REVISED
		FILE:	DRAWING NUMBER