



**MASTER SIGN PLAN  
REVIEW COMMITTEE**

**ADMINISTRATIVE HEARING NOTICE**

The **MASTER SIGN PLAN** process has been created to afford property owners flexibility in designing site and building signage, and to allow adjacent property owners the opportunity to review/comment on signage proposals prior to their approval.

**TIME & PLACE OF HEARING:** The Master Sign Plan Review Committee will meet at 3:00 p.m. on Thursday, July 10 in the Elm Room at City Hall, 2660 Civic Center Drive.

**PURPOSE:** Review a request for a **MASTER SIGN PLAN** for St. Jude Medical

**SITE:** 2305 Walnut Street

**APPLICANT:** Sign Source (MSP14-002)

**How to Participate:**

1. Call or email Thomas Paschke, City Planner, at 651-792-7074 or [thomas.paschke@ci.roseville.mn.us](mailto:thomas.paschke@ci.roseville.mn.us) prior to the hearing. Mail a letter or fax it to 651-792-7070.
2. Attend the hearing and address the Committee.

**Please see map on reverse side for property location.**

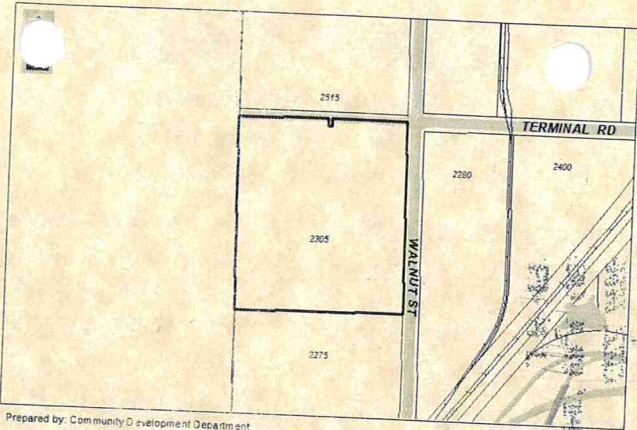

Prepared by: Community Development Department

June 30, 2014

Community Development Dept  
 City of Roseville  
 2660 Civic Center Drive  
 Roseville MN 55113

City of Roseville  
 Community Development  
 2660 Civic Center Drive  
 Roseville, MN 55113



02 1R  
 0002001686



PRIMEV BOWERS  
 \$00.34  
 JUN 30 2014

MAILED FROM ZIP CODE 55113

13