



**MASTER SIGN PLAN
REVIEW COMMITTEE**
ADMINISTRATIVE HEARING NOTICE

The **MASTER SIGN PLAN** process has been created to afford property owners flexibility in designing site and building signage, and to allow adjacent property owners the opportunity to review/comment on signage proposals prior to their approval.

TIME & PLACE OF HEARING: The Master Sign Plan Review Committee will meet at 3:00 p.m. on Thursday August 21, 2014, in the **Aspen Room at City Hall**, 2660 Civic Center Drive.

PURPOSE: Review a request for a **MASTER SIGN PLAN** for Country Inn & Suites/office building

SITE: 2730 & 2740 Snelling Avenue

APPLICANT: Sand Companies (MSP14-03)

How to Participate:

1. Call or email Thomas Paschke, City Planner, at 651-792-7074 or thomas.paschke@ci.roseville.mn.us prior to the hearing. Mail a letter or fax it to 651-792-7070.
2. Attend the hearing and address the Committee.

Please see map on reverse side for property location.



**MASTER SIGN PLAN
REVIEW COMMITTEE**
ADMINISTRATIVE HEARING NOTICE

The **MASTER SIGN PLAN** process has been created to afford property owners flexibility in designing site and building signage, and to allow adjacent property owners the opportunity to review/comment on signage proposals prior to their approval.

TIME & PLACE OF HEARING: The Master Sign Plan Review Committee will meet at 3:00 p.m. on Thursday August 21, 2014, in the **Aspen Room at City Hall**, 2660 Civic Center Drive.

PURPOSE: Review a request for a **MASTER SIGN PLAN** for Country Inn & Suites/office building

SITE: 2730 & 2740 Snelling Avenue

APPLICANT: Sand Companies (MSP14-03)

How to Participate:

1. Call or email Thomas Paschke, City Planner, at 651-792-7074 or thomas.paschke@ci.roseville.mn.us prior to the hearing. Mail a letter or fax it to 651-792-7070.
2. Attend the hearing and address the Committee.

Please see map on reverse side for property location.

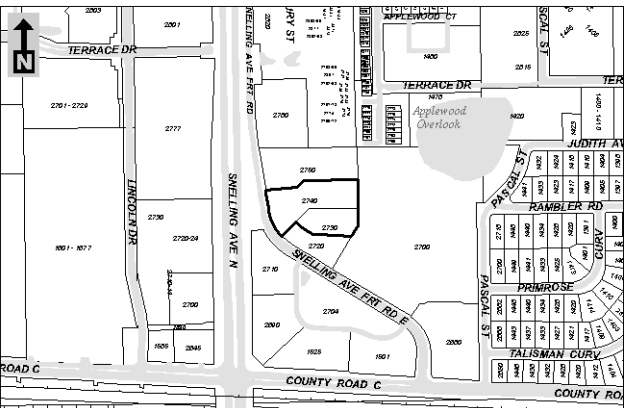

Prepared by: Community Development Department

August 7, 2014

City of Roseville
 Community Development
 2660 Civic Center Drive
 Roseville, MN 55113

Keats Roseville Llc
 6408 Oxbow Bend
 Chanhassen MN 55317-9134

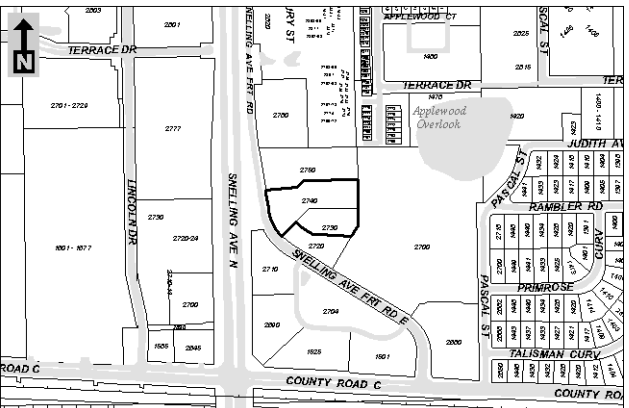

Prepared by: Community Development Department

August 7, 2014

City of Roseville
 Community Development
 2660 Civic Center Drive
 Roseville, MN 55113

Affinity Plus Fed Credit Union
 175 W Lafayette Rd
 St Paul MN 55107-1488

ParcelID	TaxPayerNa	Addressee 2	PrimaryT_4	Primary_10
032923330	Affinity Plus Fed Credit Union		175 W Lafayette Rd	St Paul MN 55107-1488
032923330	Keats Roseville Llc		6408 Oxbow Bend	Chanhassen MN 55317-9134
042923410	Tichenor, Edward J		2777 Snelling Ave N	Roseville MN 55113-1731
032923330	Roseville Hospitality		366 S 10th Ave	Waite Park MN 56387-1400
032923330	Khans li Incorporated		46 Raven Rd	St Paul MN 55127-2018
032923330	Larson Enterprises		3060 Centerville Rd	St Paul MN 55117-1105
032923330	Roseville Property Llc		40 Danbury Rd	Wilton CT 06897-4441
042923440	Har-mar Inc		1880 Livingston Ave Ste 100	West St Paul MN 55118-3426
none	Community Development Dept.	City of Roseville	2660 Civic Center Drive	Roseville MN 55113