



**MASTER SIGN PLAN
REVIEW COMMITTEE**
ADMINISTRATIVE HEARING NOTICE

The **MASTER SIGN PLAN** process has been created to afford property owners flexibility in designing site and building signage, and to allow adjacent property owners the opportunity to review/comment on signage proposals prior to their approval.

TIME & PLACE OF HEARING: The Master Sign Plan Review Committee will meet at **3:00 p.m. on Thursday, July 11, 2013 Maple Room at City Hall, 2660 Civic Center Drive.**

PURPOSE: Review a request for a **MASTER SIGN PLAN** for Trimetal

SITE: 2310 West County Road D

APPLICANT: Signs Now (MSP13-06)

How to Participate:

1. Call or email Thomas Paschke, City Planner, at 651-792-7074 or thomas.paschke@ci.roseville.mn.us prior to the hearing. Mail a letter or fax it to 651-792-7070.
2. Attend the hearing and address the Committee.

Please see map on reverse side for property location.



**MASTER SIGN PLAN
REVIEW COMMITTEE**
ADMINISTRATIVE HEARING NOTICE

The **MASTER SIGN PLAN** process has been created to afford property owners flexibility in designing site and building signage, and to allow adjacent property owners the opportunity to review/comment on signage proposals prior to their approval.

TIME & PLACE OF HEARING: The Master Sign Plan Review Committee will meet at **3:00 p.m. on Thursday, July 11, 2013 Maple Room at City Hall, 2660 Civic Center Drive.**

PURPOSE: Review a request for a **MASTER SIGN PLAN** for Trimetal

SITE: 2310 West County Road D

APPLICANT: Signs Now (MSP13-06)

How to Participate:

1. Call or email Thomas Paschke, City Planner, at 651-792-7074 or thomas.paschke@ci.roseville.mn.us prior to the hearing. Mail a letter or fax it to 651-792-7070.
2. Attend the hearing and address the Committee.

Please see map on reverse side for property location.

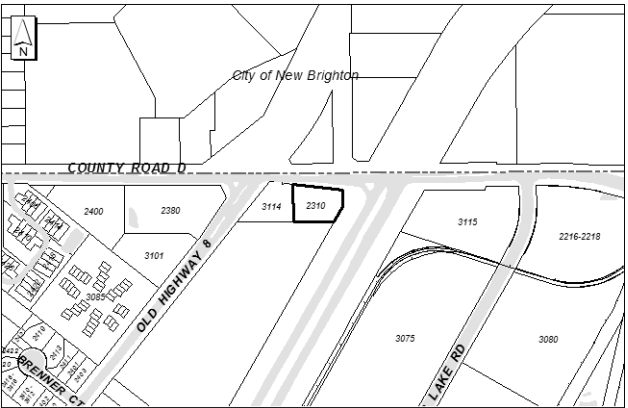

Prepared by: Community Development Department
June 25, 2013

City of Roseville
Community Development
2660 Civic Center Drive
Roseville, MN 55113

Trimetal Llc
2310 West County Road D
New Brighton MN 55112-7565

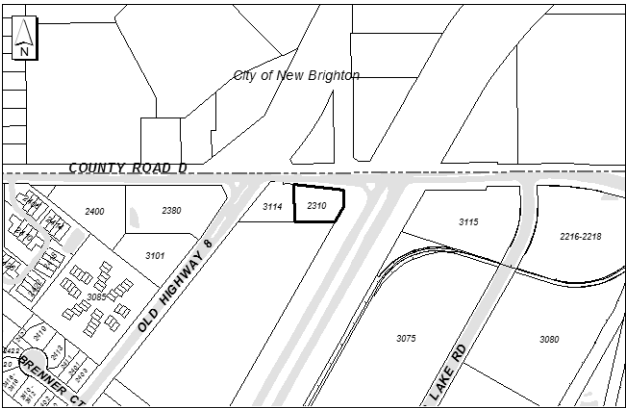

Prepared by: Community Development Department
June 25, 2013

City of Roseville
Community Development
2660 Civic Center Drive
Roseville, MN 55113

Reiling, Mary Jane
3071 Victoria St N
Roseville MN 55113-1933

PIN	TaxPayerName	TaxPayerName2	PrimaryTaxAddress	PrimaryTaxCityStateZIP
052923210007	Reiling, Mary Jane		3071 Victoria St N	Roseville MN 55113-1933
052923210006	Trimetal Llc		2310 West County Road D	New Brighton MN 55112-7565
052923210005	Thorne, Frederick W		3 Griggs St N	St Paul MN 55104-6913
052923120008	Roseville Long Lake Llc		6000 E Hein Place	Sioux Falls SD 57110-7428
052923120009	Iret Properties		Po Box 1988	Minot ND 58702-1988
	Community Development	City of Roseville	2660 Civic Center Drive	Roseville MN 55113